

A Plot of Perry County Tenn

Note- The map is drawn with south at the top of the page.

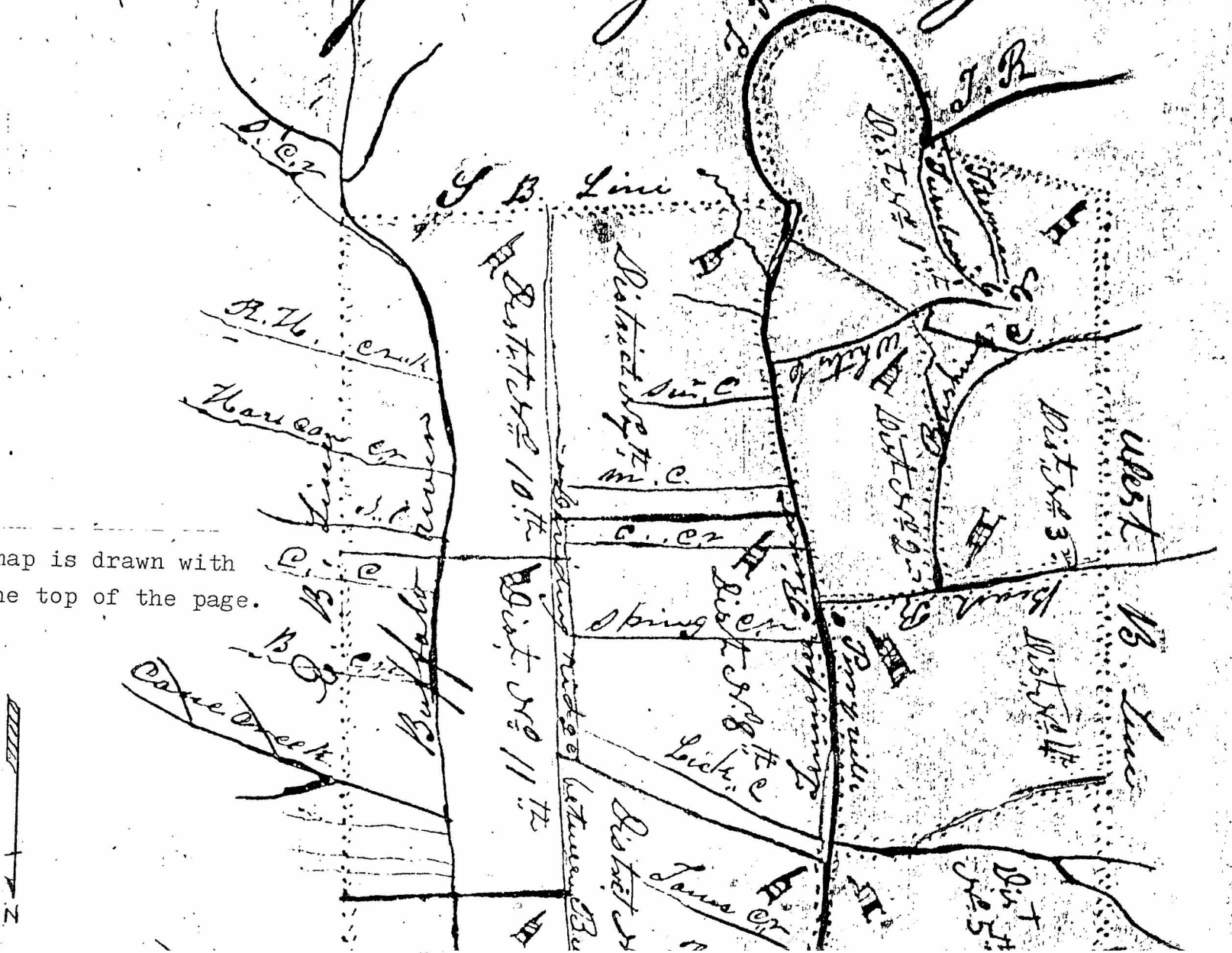

State of Tennessee, I Isaac H Standy principal surveyor Perry County 3 of Perry County on the east side of Tennessee River hereby certify that I have actually surveyed the east side of said county and that the above is a fair and accurate plat, & that it is just and true containing 557 square miles.

And further I certify that the territory petitioned to be attached by the City of Wayne as laid down on the above plat contains 85 square miles. Given under my hand this 29th September 1845. Isaac H. Standy P.S. J.R.

State of Tennessee, I William H Storm principal surveyor Perry County 3 of Perry County on the west side of Tennessee River hereby certify that I have actually surveyed the west side of said county and that the above is a fair and accurate plat & that it is just and true containing 368 square miles Given under my hand this 29th day of September 1845. Wm H Storm P.S. J.R.